

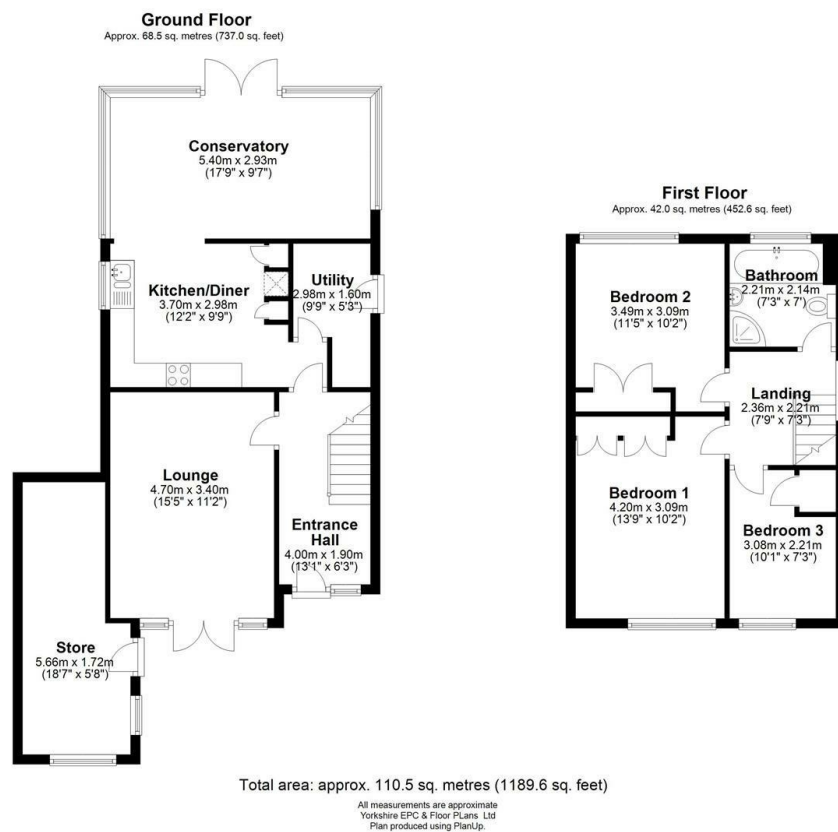

1 River View Road, Oughtibridge, Sheffield, South Yorkshire, S35

Asking Price £365,000

- SOUGHT AFTER VILLAGE LOCATION
- OFF ROAD PARKING FOR MULTIPLE VEHICLES
- COUNCIL TAX BAND D - £2,053.83
- SPACIOUS THROUGHOUT
- LARGER THAN AVERAGE CORNER PLOT
- LARGE FRONT AND REAR GARDENS
- FREEHOLD
- CLOSE TO EXCELLENT AMENITIES
- CLOSE TO LOCAL TRANSPORT LINKS
- LOCATED IN A GOOD SCHOOL CATCHMENT AREA



Directions

Viewings

Viewings by arrangement only. Call 0114 2299 060 to make an appointment.

Council Tax Band

D

EPC Rating:

D

Energy Efficiency Rating		
	Current	Potential
Very energy efficient - lower running costs		
(92 plus) A		
(81-91) B		
(69-80) C		
(55-68) D	61	69
(39-54) E		
(21-38) F		
(1-20) G		
Not energy efficient - higher running costs		
England & Wales		EU Directive 2002/91/EC